

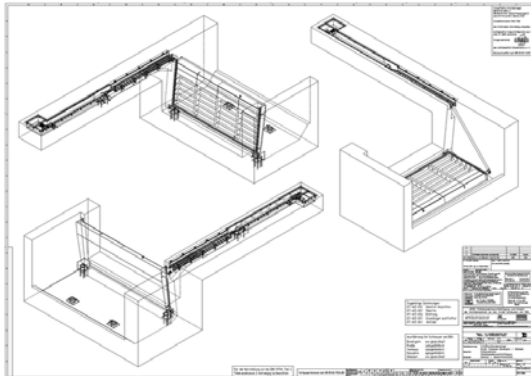

Worldwide repairs carried out with PolymerMetal[®]

REP-# 167



In November 2009 five at about 100 year-old locks were adapted to the operational and traffic-technical demands for the next years as a result of basic repair measures respectively steel hydraulics constructions improvements along the Dortmund-Ems canal. The concerned lock gates (lifting gates) are circumferentially furnished with trapezoid-shaped elastic lips. After having been moved up and bordering to the corresponding counter surfaces (gate seats) the lifting gate should close tightly. In the course of the time these gate seats showed pittings and they were no longer sufficient planar. Therefore the pasty version of the PolymerCeramic Ceramium was chosen to balance these areas. Per gate a seat area of about 20 running metres of 7 cm width with an average coating thickness up to 7 mm Ceramium was calculated. Because of the low ambient (10 °C) and work piece temperature at that season and the weather dependence the repair and curing conditions were difficult. Nevertheless after the repair the responsible water and shipping authority could release the locks respectively the canal again for the shipping according to plan.

MultiMetal
the MetalExistenceCompany[®]